

# THE SIGNAL BRIDGE

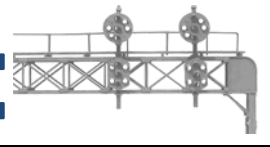

Volume 18

NEWSLETTER OF THE MOUNTAIN EMPIRE MODEL RAILROADERS CLUB  
FEBRUARY 2011 ISSUE

Number 2

Published for the Education and Information of Its Membership

## CHUCKY, TENNESSEE Southern Railway Station

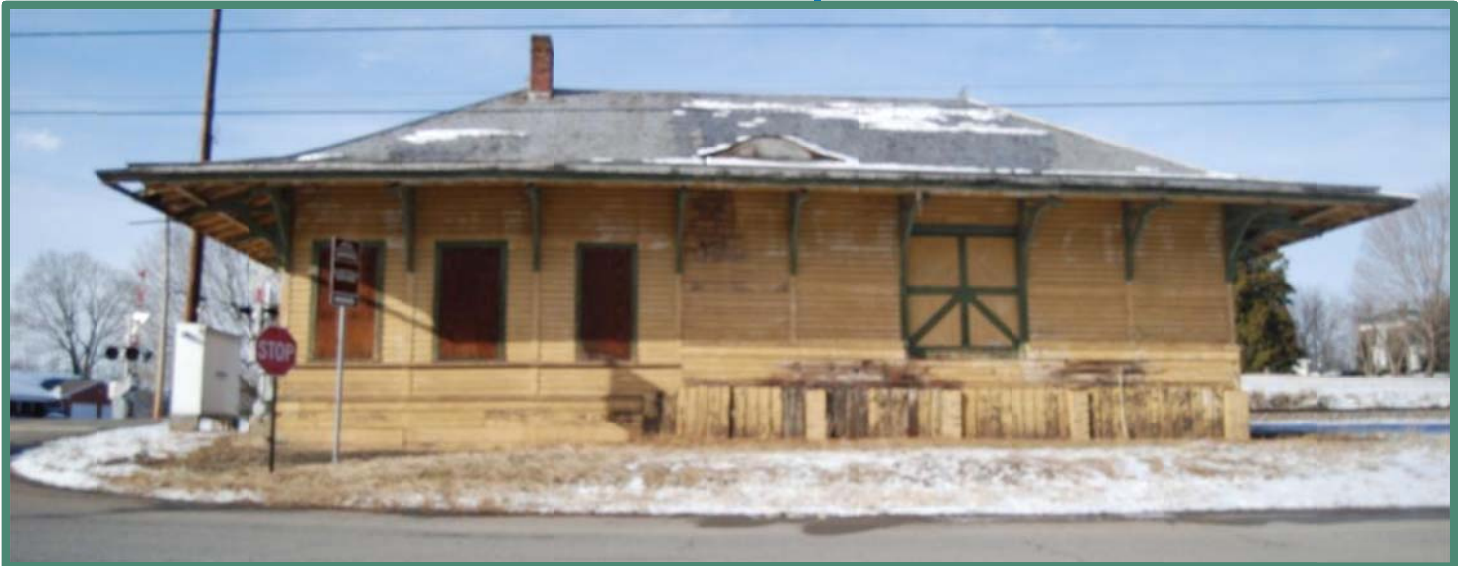

The Southern Railway station at Chucky Tennessee was built over a century ago. That it is still standing today is a major miracle and a testimony to the architects and carpenters who designed and built the structure. It may not stand much longer. Its present owner has been told move it or it will be demolished.

The floor plan is a Southern Railway standard design shared by several other small hamlet depots. The design includes a freight room, office,

and two waiting rooms harkening the days when "separate but equal" Jim Crowe laws were part of the landscape.

There have been conversations with the owners, Norfolk Southern and interested preservationist regarding taking the station down in sections, storing it until a suitable site can be found in Jonesborough where the building can be reassembled. The station would retain its Chucky identity and become a museum.

### CLUB OFFICERS

**President:**  
Fred Alsop

**Secretary:**  
Donald Ramey

**Newsletter Editor:**  
Ted Bleck-Doran:

**Vice-President:**  
John Carter

**Treasurer:**  
Duane Swank

**Webmaster:**  
John Edwards



**LOCATION**  
ETSU Campus,  
George L. Carter  
Railroad Museum

**HOURS**  
Business Meetings are held the  
3<sup>rd</sup> Tuesday of each month.  
Meetings start at 7:00 PM at  
ETSU Campus, Johnson City, TN.  
Brown Hall Science Bldg, Room 312,

Open House for viewing every Saturday from 10:00 am until 3:00 pm. Work Nights each Thursday from 5:00 pm until ??



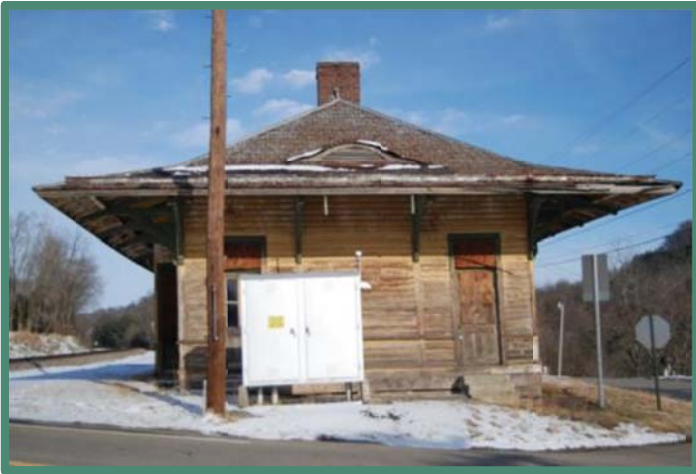

Combination Depot  
WAREVILLE S. C.  
Aug 22 - 1906

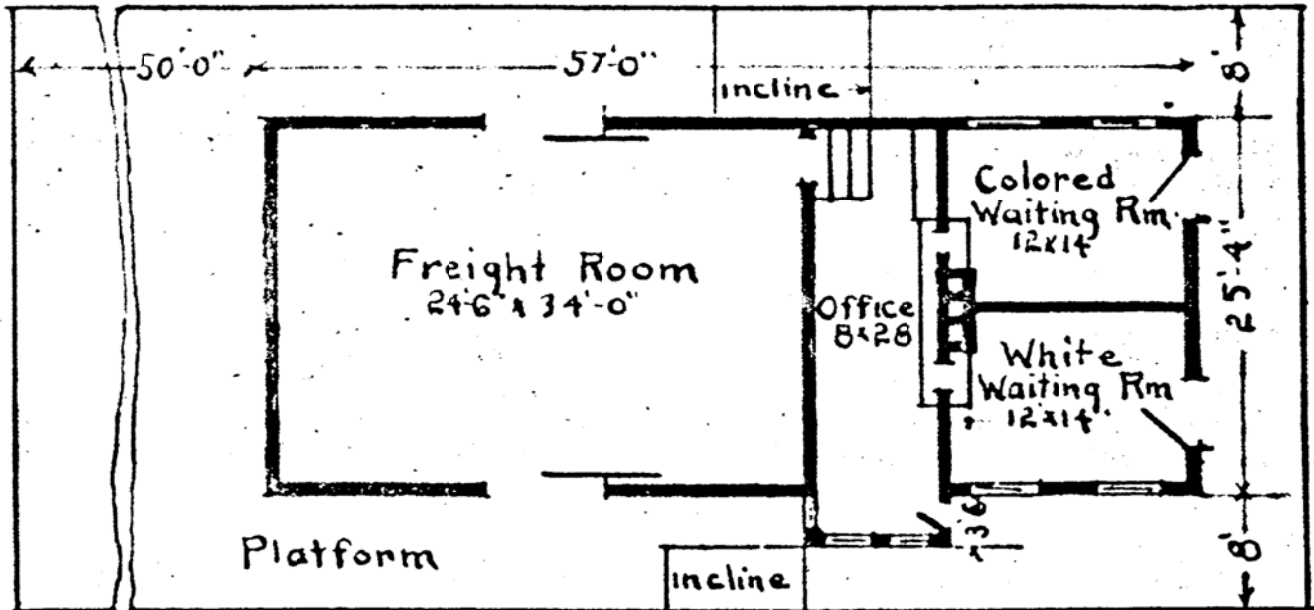

Frame Building  
 Tin Shingle Roof  
 8 Platform  
 7'-6" Overhang.

Total Cost \*2496.28  
 Per Sq. Ft. Bldg. \*1.69

**Mountain Empire Model Railroaders**  
**General Meeting**  
**January 18, 2011**  
**Minutes**

**All Aboard:** President Fred Alsop called the meeting to order at approximately 7:05p.m. with increasingly cloudy skies and a light rain falling. We had 24 members and no visitors present. Please note, meeting room may be different in February due to present seating arrangements.

**Officer Reports:**

**Secretary Report:** Secretary moved that without corrections or additions, minutes be approved as published in *The Signal Bridge*. Motion carried.

**Newsletters Editors Report:** Editor was absent this night (no report). *I must say, however, I believe our newsletter is among*

*the best of any I have ever seen. If you agree, please let Ted know. Thanks Ted for continuing your outstanding efforts. Everyone agrees there is no limit to the amount of valuable information Ted has comprised within the pages of **The Signal Bridge**.*

**Treasurers Report:** Treasurers report was given, income and expenditures reviewed, and approved.

**Note:** *Current members with unpaid dues for 2011. Please do not let your membership expire. Contact Duane Swank for remission of dues.*

**Web Masters Report:** Web site is up and running fine. E-Mail addresses for those wishing to acquire a MEMR web address are available. **NOTE:** *Thank you John for getting time-sensitive information out to the members in an orderly fashion.*

**Vice Presidents Report (upcoming programs):** John Carter reported on a current listing of upcoming programs as follows:

- February-DCC Tester- Lyle,
- March-Swiss RR Museum DVD review-Jim,



- April-Prototype Consisting-Gary.
- May-tentatively scheduled with RR story reviews..
- June-Prototype Train Orders-Gary..

**Presidents Report:**

1. Fred started off by reporting on the renovations now underway at the George L Carter Railroad Museum. Completion of these room renovations should be by end of January. We now will have a rather comfortable Library room. This should make reviewing and checking out the vast stock of material we now have much easier... The Tweetsie room has increased in size almost threefold. Emile had a preview of the proposed "NEW" track-plan for the Tweetsie layout and it was to be reviewed after the monthly meeting adjournment.
2. Fred also commented on the newly established George L Carter Chapter of the N.R.H.S. This group has had their first meeting with 24 members present.

**Old Business:**

1. Tabled discussions from Oct and Nov were reviewed:
  - Trains DVD purchase-NO.
  - 2011 dues increase- NO.
  - GLC Chapter of NRHS has been Chartered.
  - Operations on Mountain Empire Railroad is in progress (please advise if your sidings are ready for traffic. We are formulating operations at this time pending review of siding status.)
  - Dream, Plan, Build: a vote was taken to Discontinue purchasing these DVD's.
2. Follow-up letter, Allan has produced a profile of member interest for new (and OLD) members, please take the time to fill this out (in Signal Bridge-JAN edition) and return to Allan. It is requested that if you are at the museum and visitors are present, take the time to introduce yourself and interact positively with them. Also, support from the membership is needed to help support the museum operations, i.e. running trains, etc.

**New Business:**

1. The aforementioned GLC Chapter NRHS has requested space to be made available for their use in the Signal Bridge. Compensation is in place. A vote was taken: motion passed.
2. The Copyright for the GLC Museum Logo is in-place.
3. We have been asked to "think on this": Utilizing the Kids room for additional income by providing that room for birthday parties, more on this in the near future as we decide on a reasonable fee. This could become an acceptable income source.
4. We discussed our Plans for the year 2011 and they include, but are not limited to the following:
  - **January-** Our Annual Planning Month
  - **February- 11-13** Atlanta, GA RR show
  - **March- 4-WNC** RR Show in Asheville, NC  
**19-** RR Show Greensboro, NC
  - **April-** Spring Clinics on Model Railroadng  
Possible outing to Oakridge Model RR Club
  - **May-** Rail Grass,  
Racks by the Tracks,  
National RR Day,

- **June-** Museum open doors ETSU Spring Graduation  
Blue Plum Festival Johnson City, TN,  
Craggy Mtn. Railroad visit (Speeders)
- **July-** Annual Club Picnic
- **August-** Cass WV group trip
- **September- 7-10** Eastern Narrow Gauge Convention,  
ETSU Presidential Classroom visit
- **October-** ETSU Centennial;  
Doe River Gorge foliage trips;
- **November-** National Model RR Month;  
4th Anniv. Carter RR Museum;  
Saturday Model Railroad Clinics;  
ETSU Homecoming  
Bluefield WV show;  
Annual election of officers for upcoming year.
- **December-** Annual Christmas party & meeting

*Note: if you want to add to this listing, please contact Don Ramey, John Edwards, Ted Bleck-Doran*

**Co-Ordinators mtg:**

1. **G-Scale:** Jessie is busy placing passengers in the passenger cars.
2. **N-Scale:** Continues to work on Track and exploring Throttle options.
3. **Lil Engineers Room:** Laminate has been purchased to cover counter top.
4. **Displays:** Suggestions are requested for updating displays. Do you have any material you would like to see displayed and shared with our visitors. See JimP.
5. **Tweetsie:** New track-plan is being revised to accommodate increase in floor space.
6. **Cope:** Needs work, paint, repair, and Lexan protectors.
7. **HO Scale:** Staging Yard Turnouts. NCE Switch 8 board has been ordered to allow switch machine operation with DCC controllers.

**Volunteer Recruiting for Saturday Operating Sessions:**

Next 4-weeks Operator Volunteers.

*Thanks to all you engineers for your unselfish desire to come out and run your trains. This is what makes it fun for all.*

**Announcements:**

- It was brought to the attention of all in attendance that many of our younger visitors at the GLC RR Museum have been in distress with all the dead people on Paul's modules. Many have taken note that the lady on the porch was dead as were several of the other people populating that corner of our layout. There was even some discussion among the young folk as to the cause of the demise of the population due to snake bites, poison etc. As you travel around with your train while running, take note and call the appropriate personnel and let's breathe some new life into our HO counterparts.
- With no further new announcements being made, the meeting was adjourned at 9:10 p.m.

Program for the Evening: John Edwards demonstrated DCC control of Yard Switches. Motion made and carried vote to purchase the NCE Switch \* board for DCC control of Staging Yard Switches.

Next Scheduled Monthly Meeting:

February 15, 2011 - Program: Lyle Montieth, Operating DCC tester.

*Please Make Plans Now to Attend.*

**Respectfully Submitted:**  
**Don Q. Ramey**

**SPECIAL MONTHLY 'RAILROAD HERITAGE DAYS' ANNOUNCED FOR CARTER RAILROAD MUSEUM FOR ETSU 100<sup>th</sup> ANNIVERSARY**

**First 2011 program, held January 29, will be *Hootin' In The 'Hollars - An Appalachian Railroading Remembrance***

The Mountain Empire Model Railroaders, in conjunction with the George L. Carter Railroad Museum on the campus of East Tennessee State University, have set aside the final Saturday of each month as a special tribute day to specific American railroads and regions. This new program, which will use the MEMRR's large HO-scale layout and portions of the museum's display cases, will allow members and the public to enjoy uniquely-matched railroad equipment being demonstrated.

On each special day, club members are committing to bring specific models for operation on the extensive 22 x 44 foot HO model railroad, which is constructed of modular sections that were detailed by their sponsoring owners and scaled to a 1.87:1 standard. With the University celebrating 100 years since being founded with the generous support of railroad and mining magnate George L. Carter, these once-in-a-year displays will honor the heritage of both 20<sup>th</sup> century and modern rail technology.

"We thought this would be a terrific chance to schedule select operating equipment owned by our members on the layout together," says Geoff Stunkard, an MEMRR member who is coordinating the process. "Many members have very eclectic interests in both the local and far-ranging national railroads; this will give our visitors an opportunity to see some of their personal favorites in addition to the trains we normally run."

While the program is still being developed, the very first edition on January 29 will be focused on regional Appalachian lines, such as the Interstate, the Clinchfield, the Louisville & Nashville, the East Tennessee and Western North Carolina, the Norfolk & Western, the Southern and others. Called ***'Hootin' in the 'Hollers - An Appalachian Remembrance,*** the trains in operation will likely include long coal drags, merchandise and 'red ball' fast freights, mixed trains, and through passenger runs. Other highlights of the special day will be one-time displays of Appalachian-specific railroad memorabilia, books, magazines, and postcards, plus special videos on the museum's two monitors, as well as a display case of special items on 30-day loan or from the museum's library.

The George L. Carter Railroad Museum is open on Saturdays from 10:00 AM to 3:00 PM, and includes layouts in HO, N, and G gauges, and a special child's activity room. There is no admission fee but donations are welcome for its upkeep. The museum is

also seeking artifacts for the newest addition, a 1300-sq. foot room dedicated to the long-defunct, but well-remembered, East Tennessee & Western North Carolina Railroad, the 'Tweetsie' narrow gauge, which is now under construction. In addition to the displays, there is also a growing research library, a new National Railway Historical Society chapter, membership docent opportunities, and an oral history archive being established as part of the museum's programs. Info can be found online at <http://etsu> or <http://johnsonsdspot.com/glcarter/cartermuseum.htm>

The MEMRR club works in conjunction with the museum to demonstrate and maintain the model layouts, museum exhibits and other projects. More info can be found at [www.memrr.org](http://www.memrr.org). Membership opportunities are available to adults, and include special benefits and model railroading enjoyment.

**2011 Railroad Heritage Demonstration Days at the Carter Museum**

**January 29** - Hootin' in the 'Hollars - An Appalachian Railroading Remembrance

**February 26** - Looking For Some Volunteers - Tennessee Railroading from Memphis to Mountain City

**March 26** - 1<sup>st</sup> Annual STEAM UP - Steam Railroading Remembered

**April 30** - Standard of the World - the Pennsylvania Railroad

**May 28** - Here to Stay - Modern American Railroading (in honor of National Train Day May 7)

**June 25** - Song of the South - Serving Up The Southern Railroad

**July 30** - My Kind of Town - Chicago and Midwest Lines

**August 27** - The Old Reliable - The Late, Great L&N

**September 24** - How the West Was Won - Lines West of the Mississippi River

**October 29** - Nights & Weekends - Long Trains on the N&W (special evening session - start time TBD)

**November 26** - Our 100 Year Heritage - Carter's Fabulous Clinchfield Lines

**December 17** - New York State Of Mind - The New York Central's Glory Days (final day of 2011 season)

The George L. Carter Railroad Museum is located on the campus of East Tennessee State University, Campus Center Building, 100 Ross Drive. For more information contact the Museum Director, Dr. Fred Alsop, at telephone 423/439-6838.

## Outing To Cass, WV August Date Proposed

I have almost a full slate of layout tours scheduled for the year. The first will be on February 20 at Bob McCrackens. He models the N&W in HO scale. We are going to leave the museum at 1:30. For those who live toward Bristol and don't want to drive to JC, we can meet them on the way. In April, we are tentatively

going to visit Dick Congers G-Scale garden layout. July, I hope to get Jim Milhorn to let us come out and see his live steam operation. September, we are going to visit Jim Pahr's three rail layout and I hope to talk Duane Swank into letting us come over and see his Pennsy HO scale layout to round out the year. For now, please put the February one in the newsletter. Also, please....we need a head count of those interested in going? Please let me know?

## It Was Raining Trains In Louisiana Parts Fall From Sky



This is Canadian National locomotive number 2699. It is a 212 ton machine powered by a 183 liters 4400 hp V16 4 stroke diesel. Shortly before this picture was taken, whilst working under load, 2699 experienced what is known in the trade as a catastrophic uncontained engine failure. The train was passing the town of Independence, La at the time. The first picture below shows that one of the 16 cylinder packs that form the engine was ejected through the engine bay body side and thrown clear of the locomotive. In addition to this the piston from that cylinder was thrown free by the force of the failure. It was ejected so violently that it traveled through the air and crashed through the roof of a nearby home where it imbedded itself in an interior wall





**Now Available!  
 Birthday Party Package  
 for Little Engineers**



1 hour exclusive use of 'Little Engineer's Room'  
 2 hours use of decorated party space  
 Up to 20 children



**Cost: \$125.00**

The following items are also available and may be ordered at the time the reservation is made.

- 'Railroad Safety' Program (15-30min) \$25.00**
- includes free coloring books and paper hats for all children
  - presented by Railway Club member

- Additional helium-filled balloons \$1.50/ea**  
**Invitations (w/envelope) – train theme \$0.50/ea**  
**Wooden Train Whistles \$1.50/pc**



- Engineer's hat with adjustable headband \$2.00/pc**  
**Hat, Bandana, and Whistle combo \$6.00/pc**



- 'Thomas' Stickers or \$0.10/pc**  
**'Thomas' Tattoos \$0.20/pc**



**Additional Information:**

1. Parties are scheduled during normal operating hours for the George L. Carter Railroad Museum (currently Saturdays, 10:00am-3:00pm.)
2. Outside food and/or drinks are permitted. Refrigeration/freezer space is available for use during party and will be made available ½ hour before the party begins.
3. The 'Little Engineer's Room' will be reserved exclusively for your guests for 1 hour, but will also be available for additional play afterwards as long as the museum is open. Children are welcome to visit the museum exhibits (with adult supervision) as long as the museum is open.
4. Party space will include a table with disposable tablecloth and seating for up to 20 children, 'Happy Birthday' train banner, crepe paper streamers, ½ dozen helium-filled balloons, and other train-theme appropriate décor. The balloons are yours to take; other decorations remain. (Additional balloons may be ordered ahead of time for party guests.)
5. Non-refundable deposit of \$50.00 due at time of booking. Balance to be paid at time of event.
6. Any additional items ordered must be paid for when received.

Contact: Dr. Stacey Wild, [wildse@etsu.edu](mailto:wildse@etsu.edu)  
 (423)439-5129

All proceeds benefit the  
 George L. Carter Railroad Museum

## THE VIEW FROM THE ENGINEER'S SIDE OF THE CAB:

MEMRR members; we want you back!! If you are reading this issue of *The Signal Bridge* **and you have not as yet paid your dues your annual membership has expired and you will receive no more issues.** Don't lose all the privileges of MEMRR membership including club activities, unlimited access to the Carter Railroad Museum model railroad layouts, and the fellowship of this dynamic model railroading club by failing to renew your membership. Our dues are inexpensive; they have not been raised in many years. You get a lot for the small cost of your membership. Annual dues are paid beginning in late November when we elect club officers for the year and members have a long, 3-month period ending on January 31<sup>st</sup> (based on our current 2008 Bylaws) to renew. Personal letters as a last reminder were mailed to everyone the treasurer indicated where in arrears on February 3<sup>rd</sup>. We don't want to lose any member and if there is anything the club can do to make your membership more personally satisfying to you, please don't hesitate to let any of us know what it is. We want you to enjoy all the benefits a club such as ours has to offer and we look forward to your suggestions for improvement. The club depends on member's dues for support of regular publications like *The Signal Bridge*, club fliers with membership application forms, special club projects such as the current construction of a new staging yard and freight yard (lumber, wiring, structures, track, switch machines, materials, Digitrax hardware, etc.). But we depend on much more than your annual dues, we depend on you as the critical mass that keeps the organization moving and energized to balance our commitment to the University and its railroad museum. ETSU provides the space, the utilities and the overhead in return for the club's activities that keep our exhibits fresh, our model railroad layouts operating, our meeting rooms, and our outreach to the citizens of the area who visit us every Saturday. The train is rolling down the tracks with MEMRR club members on board. Don't be left behind. 2011 will be an exciting year for the MEMRR with lots of activities already planned inside and outside of the Carter Railroad Museum.

The **January 13<sup>th</sup> Coordinator's Meeting** highlights are as follows: The Club HO layout will bring a plan to use a computer-based software to throw the 8 tortoise-linked turnouts on the new staging yard. Discussion was led by **John Edwards** and he will demonstrate the systems capability at the January business meeting. **Tod Eaton** reported new track was being installed under the N-Scale's helix and that research was still on-going for a new power supply and remote control system for the Bankus layout. **Jesse Kittle** stated the Large-Scale group is working on the passenger cars and installing passengers for that layout. **Gary Emmert** said the Cope Layout will get new paint on the benchwork, legs repositioned, and repair on a non-functional turnout. **Rich Gallaher** will assume some coordinator duties for the Tweetsie layout construction. **Emile Hamm** is currently working on a track plan with the helpful input of others in that group. Fred has worked up a plan for benchwork for the project. **Gary Rabetoy** is working with vendors who may be able to supply rolling stock that is not yet on the market for ET&WNC. **Duane Swank** will soon be installing a new counter top on the large storage cabinet in the Little Engineers Room purchased by the museum. **Jim Pahr** and **Geoff Stunkard** will be putting new displays, including a lantern display, in 3 of the cases and removing the wooden train display. **Duane Swank** reports a good

inventory of engineer hats on hand; club shirts and jackets can be ordered from him at any time. There was discussion about the possibility of having club or museum cars such as 55 ton hoppers or perhaps passenger cars in ETSU colors (blue & gold) with ETSU's 100<sup>th</sup> anniversary logos for sale as a fund raiser. We need club input on this. **Fred** and **Hobie Hyder** continue to work on publicity for the club/museum and will be planning more Storytelling (story collecting events for 2011). **Hobie Hyder** reported he will be planning some club visits to member's home layouts during 2011 as well as club railfanning trips to such place in West Virginia as Cass Scenic Railroad and Elkins. Details forthcoming. **Ted Bleck-Doran** reported the January issue of our newsletter will be 16 pages large. He wants to do a series on the railroad stations of the area and is seeking photos and text. If the club approves, he will provide space in the newsletter for the newsletter of the newly formed Carter Chapter NRHS as we have club members in that organization as well.

**Carter Railroad Museum news:** The renovation of the newly acquired space adjoining the Ken Marsh room was completed in late January including the removal of the wall that portioned the two rooms and thus providing a large display space exceeding 1,300 sq.ft. The museum's new railroad library is shelved and we are in the process of seeking donations of laminate to line the wooden shelving with prior to stocking them with hundreds of donated books and magazines. We will seek to obtain a computer and a DVD player for the room as well so club members can screen the scores of railroading DVDs, including the Dream, Plan, Build series we have been purchasing. We will also seek donations from local building material supply stores for the lumber needed for the benchwork that will support the new Tweetsie layout to be constructed in the new space. The ETSU key shop will soon rekey the doors in all the renovated space to our single 113 master key. The window air conditioner in room 113 has been installed in the wrong window and that contractor's error will be corrected just as soon as a new panel is delivered to place it in the proper (middle) window in our big display gallery. Two new ceiling lights have been installed in the hallway making it both brighter and safer.

Working with **Delanna Reed** of the ETSU Graduate Program in Storytelling we will plan at least 2 more Saturday storytelling events for March and April. In addition, Delanna is currently teaching a graduate class that will focus on collecting these stories and the students will be going out to the homes of some of the folks we have already interviewed to record additional stories.

The Carter Museum has entered the Little Engineer's Birthday Party venue. **Stacey Wild**, a colleague of mine in the Biology Dept., has agreed to be our birthday party coordinator and has put together a Party Package advertising our program and services. The museum will be the sponsor and the parties will act as small fund raisers for the museum. We had our first party on Saturday, 5 February, and it was most successful. Check out the Party Package on the club website and tell your friends with small children about it. We already have another party lined up for March and more in the making. I'll be happy to give you details at the February Club Business Meeting.

At our January club meeting **Geoff Stunkard** presented an idea to increase the excitement of our Saturday operating sessions on the HO-Scale layout, but one that will also provide regular publicity for the club and the Carter RR Museum. Geoff suggested that we



dedicate one Saturday a month to run only trains representing a specific railroad, a suite of railroads, or a particular geographical region. The club discussed the idea at length, got on board with it and voted to try it out for a year. Heritage Days at the Carter Railroad Museum was born. By the next day Geoff had worked up a 12-month schedule based on the club's input that will make each 4<sup>th</sup> Saturday of the month a **"Railroad Heritage Day"** and by the end of the day our press release draft was in the hands of ETSU's University Relations office. We got such terrific response to the media releases (newspaper, TV, radio, and publications like "The Loafer") that we had one of the largest crowds in our 3-year history at the Railroad Museum on January 29<sup>th</sup>. We were packed and lots of our members brought their favorite trains to represent our first Heritage Day event, "Hootin' in the Hollars'-Appalachian Railroads Remembrances ". Look for a listing of these upcoming events at the museum on the club website. Put these event dates on your calendar and let Geoff know if you are going to participate and what you are going to bring to run on that day. With lots of trains to operate scheduling a time slot may be important. Remember, they will be on the **4<sup>th</sup> Saturday** of the month. February's theme is, **"Looking for Some Volunteers—Railroading from Memphis to Bristol"** and we will run it on Saturday, February 26<sup>th</sup>. Any railroad that ran in or through Tennessee, N&W, Southern, L&N, ET&WNC, Tennessee Central, NC&StL, IC, CSX, NS, and many more, should be on the roster. Sign up and bring them in. We will get the publicity out and we should have lots of people dropping by to see your Tennessee train do its thing.

The new Carter Chapter NRHS had its inaugural meeting on January 17<sup>th</sup> with 24 or so members present. They will be meeting on the Monday evening preceding our MEMRR Tuesday night meetings. Meeting time is 6:30 and they are currently using room 312 (MEMRR's meeting room) in Brown Hall. Everyone is

invited to attend and invitations for membership are extended. They will receive their club charter at their February meeting on the 14<sup>th</sup>.

We are busy as always with lots of projects underway. A major effort has gone into cleaning up the large workroom, #108, across the hallway from our large gallery in #113. That room will become more important as a club workspace with its storage cabinets, cabinet-top working area, paint spray booth and tables, as we lose some of our traditional work space inside the HO layout to its expanding rail yards. It will be critical to keep the big workroom functional and clutter free. As we move the books now stored in it to the new library it will become even more 'roomier' and better to do some of our small projects in. We have moved the Cope Layout out of it as well opening up more space for storage and for placement of a refrigerator. There are some storage drawers available for you to place some of your projects-in-progress in if you want to work on them there, but not for storing rolling stock and other personal items that should be kept under your module.

February is rolling by all too quickly. We have put together an active calendar of events for 2011 and we look forward to another year of interaction with each other as we enjoy our hobby and bring it to the many visitors to the museum. We have a great opportunity in our relationship with ETSU and the Carter Railroad Museum. Let's continue to make the most of it. Happy Rails to YOU!!!. Hear the whistle blow and dream of all the destinations yet to come.

Fred Alsop  
President, Mountain Empire Model Railroaders  
Director, George L. Carter Railroad Museum, ETSU

## SIGNS AND POSTERS IDEAS FOR THE LAYOUT

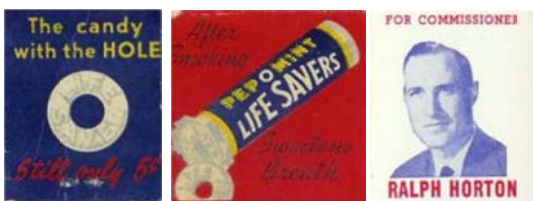

These posters are from the Match Book Cover collection of Geoff Stunkard. They may be cut out and attached to the sides of buildings or fences as paper billboards – or – they can be printed on decal sheets (be sure to use sheets with white background) and affixed to brick walled structures.

The larger signs are approximately 4 foot high in O Scale – 8 foot high in HO.



The smaller signs are 2 foot in O Scale – 4 foot in HO.

If printed on paper don't forget to sand the back side of the paper to thin the profile.

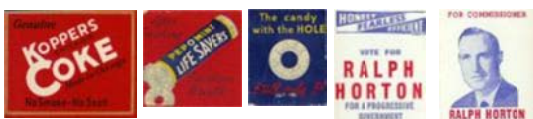

The printed side can also be sanded to fade the lettering.

Light washes of thinned India ink and isopropyl alcohol can be used to further weather your signs.

**Membership Inventory**

First, let me thank you for being a member of the Mountain Empire Model Railroaders Club. I hope that the next year as a MEMRR member will open new doors to new enjoyment for you and your interest in model railroading.

It doesn't matter if you are a seasoned veteran or new to the hobby, membership in the MEMRR gives you the opportunity to learn new skills, develop your modeling techniques and meet new friends that share your interest in the hobby.

Please take this time to let us know what area(s) of the club you would be interested in participating in and can support in the coming year and return your completed questionnaire to Allan Morton or any club officer. Thank you.

(Check all that apply)

- HO Scale Layout*                       *N Scale Layout*                       *G Scale Layout*
- HOn3 Tweetsie Layout*                       *Traveling HO Layout*                       *Kids Play Room*
- Museum Display Cases*                       *Library Development*

Based on the above response, what would you like to learn more about or help develop?

(Check all that apply)

- Track Laying*                       *Electrical DC/DCC*                       *Scenery and Detailing*
- Layout Maintenance*                       *Bench Work*                       *Research*
- Other (Specify ):* \_\_\_\_\_

I consider my skill level to be:  *Beginner/Novice*     *Intermediate*     *Expert*

What are your expectations from membership in the club?

\_\_\_\_\_

How can the club help you achieve your goals?

\_\_\_\_\_

We look forward to seeing you at our weekly Thursday night working sessions at the George L. Carter Railroad Museum on the East Tennessee State University campus and at our monthly meeting the third Tuesday of each month.

Fred Alsop  
President, Mountain Empire Model Railroaders





# ***The George L. Carter Chapter NRHS Newsletter***

**Vol. 1, No. 1**

**February, 2011**

## **The Birth of a new NRHS Chapter; Organizational Meeting Held; Chapter Receives Charter!**

**By Mike Jackson, Editor**

After months of planning, discussions by prospective members and persons interested in the project, and a series of meetings, the new George L. Carter Chapter of the National Railway Historical Society (NRHS), sponsored by East Tennessee State University (ETSU), Johnson City, Tenn., is finally a reality!

A product of meticulous preparations, the proposed George L. Carter Chapter was granted an NRHS Charter in October, 2010, at the NRHS Fall Conference, Lancaster, Penn. The first meeting, an organizational session during which the proposed by-laws were discussed and approved, a slate of officers and members of the board of directors were elected, and the goals of



the Chapter were discussed, was attended by 22 members and visitors in Brown Hall on the ETSU campus on January 17. At the Winter Conference, January 29-30, 2011, in Williamsburg, Va., the Carter Chapter received its charter as one of the newest additions to the NRHS. The 24-member Chapter has joined the NRHS family of active chapters that number 161.

The initial meetings concerned the need for and the purpose of a new NRHS chapter in the area and the procedures involved in applying for the charter. Additionally, meetings were held that included work on a proposed set of by-laws and goals for the Chapter.

After the charter was approved in October, 2010, an organizational meeting was scheduled in December, but this session was postponed because of the weather conditions. Finally, on January 17, 2011, members and visitors attended the organizational meeting.

Fred Alsop (pictured at left)—the interim president of the proposed Chapter—presided over the meeting during which he introduced an agenda that covered several important topics: proposed by-laws, election of officers and a board of directors, location, date and time of the meetings, NRHS and Chapter dues, appointments of non-officer positions, and goals of the Chapter.

Without any objection and in a spirit of harmony that highlighted the discussions, all the items on the agenda were discussed, approved, and officers and directors (pictured below) were

elected. Dr. Alsop also announced appointments to the key positions of membership chair and newsletter editor.



**The officers, directors, and presidential appointees of the George L. Carter Chapter NRHS who were elected and selected at the January 17 organizational meeting are: kneeling from left Duane Swank, treasurer, and Jim Pahrns, vice-president and national director. Standing from left are Mike Jackson, appointed newsletter editor, Betty Jackson, secretary, Fred Alsop, president, Bill Hensley, at-large director, Harriet Swank, appointed membership chair, and Dan McLeod, at-large director.**

The goals of the Carter Chapter include but are not limited to the following points:

- (1) Collect and archive railroad stories from retired railroaders and their family, and make a storytelling event a regular feature in conjunction with the Jonesborough, Tenn., Storytelling Center.
- (2) Coordinate a program with the Boy Scouts of America (BSA) and scouts who want to work on earning the BSA Railroad Merit Badge.
- (3) Support the educational outreach of the George L. Carter Museum and enhance its railroad collections.
- (4) Locate railroad artifacts suitable for archiving at the Carter Museum and the Archives of Appalachia at ETSU.
- (5) Promote and preserve the past, present and future of local and national railroads.
- (6) Grow the Chapter's membership.



# Introducing the George L. Carter Chapter NRHS Newsletter

By Mike Jackson, Editor

The George L. Carter Chapter of the National Railway Historical Society (NRHS) decided at its January 17, 2010, organizational meeting to launch a monthly newsletter, and you are reading the first of what I hope will be a continuous and a long-running publication.



As editor, I pledge to prepare and distribute an informative newsletter each month that will include not only chapter news and features, but also items of interest from other NRHS clubs and organizations and railroad companies.

One thing is certain, however, and that is I will need your help. If you have anything to contribute, please do send it to me. If it is an item from another publication, we will need their permission to reprint. If you have any ideas for improvements that can be made to the newsletter, please feel free to contact me.

I am thankful for the assistance of Duane and Harriet Swank. They will take care of proof reading and putting the final touches on the newsletter before I send it to you.

Remember, this is your chapter's newsletter, and that means you are an important part for the preparation and for any success this publication will achieve.

My email address is [ki4ojomichael@gmail.com](mailto:ki4ojomichael@gmail.com) and my phone number is 423-914-6751. Please don't hesitate to contact me if you have any ideas or suggestions. Thanks!

**East Tennessee & Western North Carolina RS-3 210 bringing a load of coal to North American Rayon Corp., Elizabethton, Tenn., in this August 1977 picture by Betty Jackson**



## The Drawbar

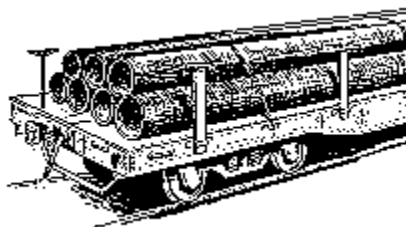

It is with pleasure and pride that I write my first column as President of the George L. Carter Chapter NRHS. The fulfillment of this moment has been months in the planning and is the culmination of the hard work and dedication of a number of people, all of whom are far more experienced in the workings of the NRHS at both local chapter and national levels than am I. It has been my privilege to be included in the evolution of an idea that now is reality in the tangible form of a functioning NRHS chapter of 24 members with

diverse backgrounds coming together to embrace new projects and to grow a newly formed organization. I welcome the promise of promoting railroading in a new way on the ETSU campus and the challenge of helping our chapter select the tracks it wants to run on. *"Hear the whistle blow and dream of all the destinations yet to come."*

I wish to thank everyone who has worked to get us to this place in our short history; especially, Jim and Charlotte Pahrís, Duane and Harriet Swank, Michael and Betty Jackson and Gary and Darlene Tregaskis. Jim has long served as a NRHS National Director and as such he brings to us a long list of personal contacts with officers and board directors from across the region and the nation. Jim, Duane, Betty and Harriet served along with me as interim officers for the purpose of our chapter's application process to National, and to conduct the first meeting of the chapter. Jim, Duane and Betty have now been duly elected as officers; Vice-President and National Director, Treasurer, and Secretary, respectfully. Michael Jackson, a person with considerable newsletter editing and production experience, has accepted an appointment as Editor. Likewise, Harriet Swank has agreed to serve as our Membership Chairman. I hope to fill the positions of Librarian and Historian in the near future. Bill Hensley and Dan McLeod were elected to the Board of Directors. We are indeed fortunate to have people who are experienced and willing to serve the chapter in all our elected positions. This new chapter is off to a great beginning.

I also wish to express my gratitude to our members for seeing the potential this new chapter associated with the George L. Carter Railroad Museum has, and by your membership joining us on this new adventure in railroading, railroad preservation, railroad archiving, education, service and public outreach. We have identified several important projects and goals for the Carter Chapter and are most grateful for your positive response to them and your support as we get them underway. There will be plenty of things for everyone to do and I look forward to working with each of you, getting to know you and your special talents, and building this chapter into an exciting and interesting organization that we can all share and enjoy. Welcome to the George L. Carter Chapter NRHS and welcome to the George L. Carter Railroad Museum. It's going to be a grand adventure! The track is clear ahead and we have a green light. Release the brakes and let's begin the journey together. You can reach me at [fredjalsop3@earthlink.net](mailto:fredjalsop3@earthlink.net) or by phone: (h) 423/929-FRED or (o) 423/439-6838.

Fred J. Alsop III, President, George L. Carter Chapter NRHS  
Director, George L. Carter Railroad Museum ETSU



***Railroad news items in the George L. Carter Chapter NRHS newsletter each month are provided by the media/public relations departments of Amtrak, Burlington Northern Santa Fe, Canadian National, Canadian Pacific, the Federal Railroad Administration, Genessee & Wyoming (owner of the East Tennessee Railway and provider of rail car switching in this area), Kansas City Southern Railway, Norfolk Southern Railway, the Tennessee Valley Railroad Museum, Three Rivers Rambler, and Union Pacific Railroad and are used with their permission.***



## **The George L. Carter Chapter NRHS**

The Monthly Meetings are the Monday preceding the third Tuesday, 6:30 PM in room 312 of Brown Hall, East Tennessee State University, Johnson City, TN. The room is on the third floor entering from the northeast entrance doors. The room for future meetings TBD. For more information, please write to the Chapter at 1763 Sylvan Hill Road, Elizabethton, TN 37643.

The George L. Carter Chapter NRHS Newsletter is prepared and distributed monthly prior to the meeting. Opinions expressed by the writers are not necessarily the views of East Tennessee State University and its employees, and the George L. Carter Chapter NRHS, and its members, officers, and board of directors. Contributions are welcome. For permission to use the material in this newsletter, please contact the editor, Mike Jackson. Contributors are Fred Alsop & Jim Pahrís. Railroad clip art is used courtesy of Ken Houghton of Houghton's Rail Images. Please send correspondence to Mike Jackson at [ki4ojomichael@gmail.com](mailto:ki4ojomichael@gmail.com) or call 423-914-6751.